



Novotel Paris Centre Tour Eiffel
61 Quai de Grenelle
PARIS CEDEX 15 - 75738

MEETINGS BY NOVOTEL, DESIGNED FOR QUALITY TIME



Hello,

Thank you for your interest in Novotel Paris Centre Tour Eiffel as the venue for your event.

At Novotel, we believe that quality time is about making everyday moments matter. Everything has been thought to enhance our guests' life balance, sense of well-being but also enjoyment.

Whether through our intuitive & modern design or our large range of rewarding experiences, everyone can disconnect from a busy life or make time to connect with their family, friends or colleagues.

This combination makes Novotel the perfect spot for travelers and locals to have a drink, a bite to eat, to work, play or just relax.



At Novotel Paris Centre Tour Eiffel, our professional and creative team of event planners overseen by an expert Event Manager, are on-hand to ensure a flawless affair from start to finish. This team, along with innovative technology, beautifully appointed venues and meeting spaces, and sublime catering options, guarantees an unparalleled occasion.

Stay in the heart of the capital city at Novotel Paris Centre Tour Eiffel. For a romantic weekend, family holidays or business trip, our hotel will immerse you in the City of lights while offering you spacious and comfortable rooms. Parisian monuments, museums, shopping and meeting rooms,, everything is nearby. Appreciate the authentic Japanese gastronomy at the restaurant Le Benkay. Enjoy for a relaxing moment the fitness room or the covered pool. Live at the Parisian time at Novotel.

The offer we'll make will be based on your requirement but can easily be adjusted or changed to your needs. We look forward to assisting you in making this important event memorable.

The Novotel Commercial team

By joining ALL Meeting Planner Loyalty Program, you will be rewarded with Points ALL for this event



ACCOMMODATION



DOUBLE STANDARD ROOM

Our double standard rooms welcome from 1 to 3 persons, according to their fitting :

- . 264 rooms with a double bed (queen size)
- . 68 rooms with a double bed (queen size) and a single sofa

Free WiFi, TV with flat screen, courtesy plate and minibar (1 complimentary bottle of water), air conditioning, individual safe and phone.

Bathroom with complimentary items, hair dryer, shower or bathtub.



TWIN STANDARD ROOM

Our twin standard rooms welcome from 1 to 2 persons

- . up to 330 rooms with 2 single beds

Free WiFi, TV with flat screen, courtesy plate and minibar (1 complimentary bottle of water), air conditioning, individual safe and phone.

Bathroom with complimentary items, hair dryer, shower or bathtub.



SUPERIOR ROOM

Our superior rooms welcome from 1 to 4 persons, according to their fitting

- . 6 rooms with a double bed (queen size)
- . 27 rooms with a double bed (queen size) and a single sofa
- . 132 rooms with a double bed (queen size) and a double sofa

Free WiFi, TV with flat screen, courtesy plate and minibar (1 complimentary bottle of water), air conditioning, individual safe and phone.

Bathroom with complimentary items, hair dryer, shower or bathtub.



JUNIOR SUITE

Our Junior suites welcome from 1 to 4 persons
. 6 Suites with a double bed (queen size) – semi private bedroom - and a double sofa (lounge)
Free WiFi, TV with flat screen, Nespresso & tea pot, minibar, 1 complimentary bottle of mineral water, air conditioning, individual safe and phone.
Bathroom with complimentary items, hair dryer, bathtub, bathrobe and slippers.



EXECUTIVE SUITE

Our Executive suites welcome from 1 to 4 persons
. 6 Suites with a double bed (king size) in a private bedroom, and a double sofa (lounge)
Free WiFi, 2 TV with flat screens, Nespresso & tea pot, minibar, 1 complimentary bottle of mineral water, air conditioning, individual safe and phone.
Bathroom with complimentary items, hair dryer, bathtub and rainshower, bathrobes and slippers.

HOTEL EVENT MEETING SPACE & VENUES

CONVENTION CENTER



For all your venues from 10 to 600 people.

3000SqM of meeting spaces (on 2 levels).

Amphitheater of 600SqM, fully renovated, modular and totally equipped (audio & video control room, stage manager on site, translation cabins). Retractable tiers.

29 other meeting rooms, for the greater part with natural daylight and adjustable.

Food & beverage spaces with an incredible river Seine view.

Professional team in your listening and at your disposal.

AUDIO VISUAL SERVICES



All our meeting rooms are equipped with a beamer and a screen (no sound system).

This service is included in the meeting room location rate.

The Amphitheater includes a beamer, a control desk with 2 goose neck microphones and 2 HF hand microphones.

Our audiovisual supplier stay à your disposal to prepare you a tailor-made quote.

BANQUETING



Because these moments of sharing are important for you, our team is there, in your listening and according to your desires, to be strength of proposals and help you in the choice of your catering.

Breaks, menus 2 or 3 dishes, buffets, aperitifs, finger buffets (lunch/dinner), gala dinner,...

Leave our Chef inspire you by his suggestions, recommendations, or his various thematic proposals.

You have a wish or a specific requirement?

Do not hesitate to tell us, we will be pleased to prepare you a tailor made offer.



NOVOTEL CAFE RESTAURANT

Our restaurant benefits of an ideal location with its wide picture windows, offering a fantastic view on the Seine.

We welcome you in the Novotel Café every day for your breakfast (buffet) and your dinners.

Our menu proposes you a simple, delicious, healthy and well balanced French cooking to eat as you wish!



GASTRONOMIC JAPANESE RESTAURANT « LE BENKAY »

With a sensational view on the Seine, the Benkay restaurant will transport you to the land of the rising sun.

Discover the Japanese gastronomy in our Washoku space, where our Japanese Chefs perpetuate with "savoir- faire" the ancestral gestures.

Our Sushi Master realizes directly in the counter, the Sushi and the Maki which will be served to you still warm, according to the Japanese rule book.

Take advantage of our private rooms with a view of the Seine for your lunches, dinners or cocktails, with tranquility.

And for an complete disorientation, Teppan Yaki, cooking on heating plate, will offer you an unforgettable experience, even visual as gustative.



BAR « G.G'RENELLE »

Intimist, cosy and smart.

Ideal for a professional meeting, a business breakfast, a drink with friends or a quick and light lunch.

In summer season, take advantage of our terrace, real "balcony" on the Seine



RELAXATION

"Blue Fitness Center" club :

- . Indoor heated swimming pool with opening roof and a panoramic view of the Seine

- . Fitness room : cardio, body building

- . Sauna

Relaxation area by Sothys :

- . Massages (on request & paying)



OTHER SERVICES

- . Room service 24 hours a day
 - . Snacking "Instant Nomade" 24 hours a day
 - . Free WiFi in all the hotel and free access to the Web Corner Mac
 - . Concierge service & multi-lingual virtuel Concierge
 - . Car valet service
 - . Luggage porter service (on request & paying)
 - . Gift shop
 - . International staff (6 spoken languages)
 - . Private car park (50 places), non privatizable
-

FLOOR PLAN LEVEL 2 "ESPACE SEINE"

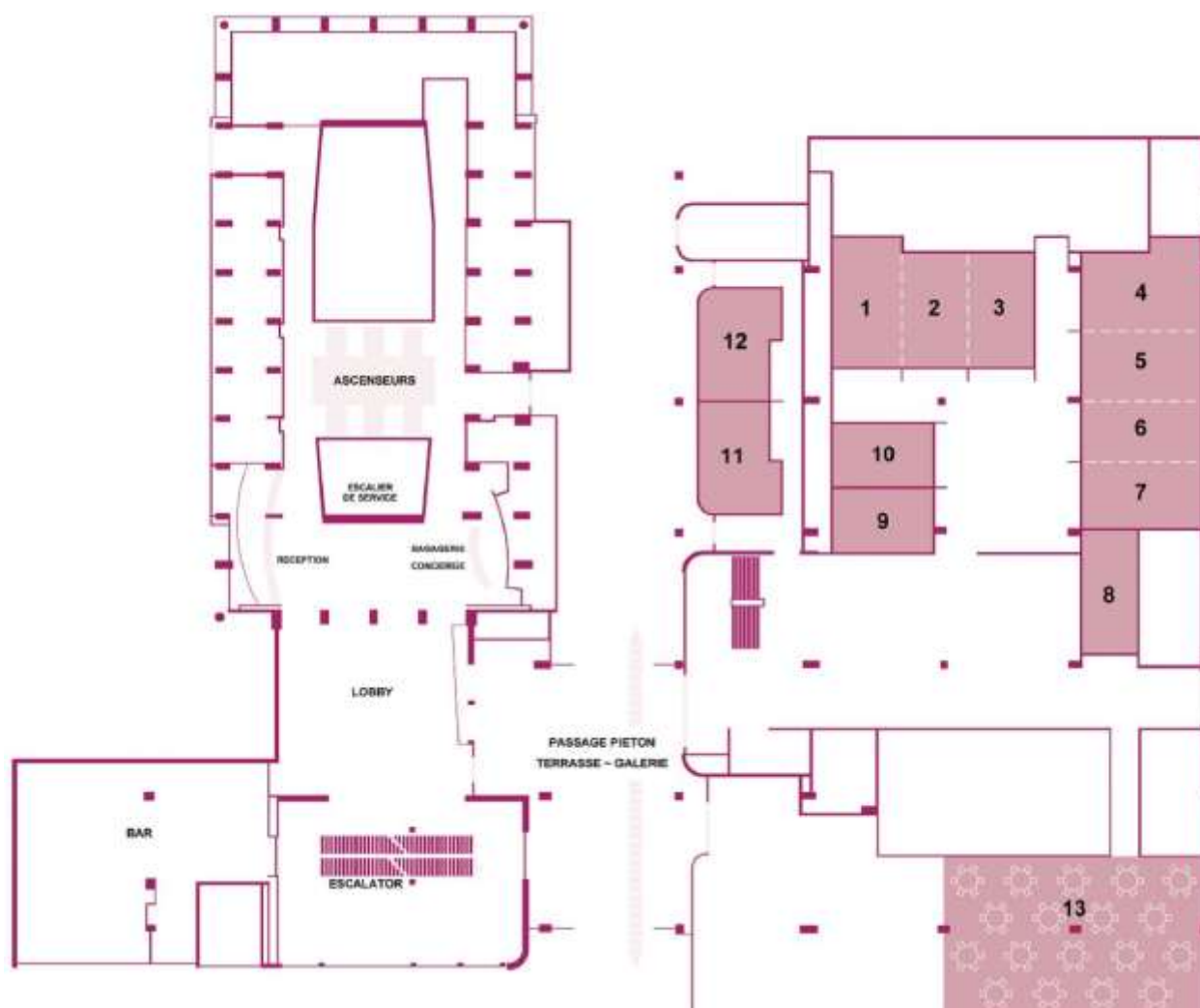

MEETING ROOM CAPACITY ESPACE SEINE

| ESPACE SEINE Niv 2 | Salon / Meeting Room | Surface m2 / Area m2 | Surface / Square Feet | Longueur / Length | largeur / width | Hauteur sous plafond / Ceiling Height | U ouvert / U shape | U fermé / Boardroom | Classe / Classroom | Théâtre / Theatre | Cabaret / Cabaret by 7 | Banquet / Banquet | Cocktail / Cocktail |
|--------------------------|---------------------------|-------------------------|--------------------------|----------------------|--------------------|---|-----------------------|------------------------|-----------------------|----------------------|---------------------------|----------------------|------------------------|
| 1 | Tamise | 45 | 484 | 9,2 | 4,9 | 2,6 | 22 | 28 | 20 | 42 | - | - | - |
| 2 | Tage | 37 | 398 | 8,1 | 4,6 | 2,6 | 18 | 20 | 18 | 30 | - | - | - |
| 3 | Loire | 37 | 398 | 8,1 | 4,6 | 2,6 | 22 | 24 | 18 | 36 | - | - | - |
| | Tamise Tage | 82 | 882 | 9,6 | 8,1 | 2,6 | 28 | 36 | 40 | 60 | 28 | - | - |
| | Tage Loire | 74 | 796 | 9,1 | 8,1 | 2,6 | 28 | 36 | 40 | 60 | 28 | - | - |
| | Tamise Tage Loire | 119 | 1280 | 14,2 | 8,1 | 2,6 | 44 | 52 | 64 | 90 | 48 | 70 | 100 |
| 4 | Rhin | 46 | 495 | 8,4 | 5,5 | 2,6 | 22 | 28 | 24 | 40 | - | 30 | 40 |
| 5 | Volga | 41 | 441 | 8,4 | 4,9 | 2,6 | 20 | 24 | 24 | 38 | - | 20 | 35 |
| 6 | Douro | 36 | 388 | 8,4 | 4,3 | 2,6 | 20 | 24 | 20 | 30 | - | 20 | 30 |
| 7 | Amazonie | 38 | 409 | 8,4 | 4,5 | 2,6 | 20 | 22 | 20 | 35 | - | 20 | 30 |
| | Rhin Volga | 87 | 936 | 10,4 | 8,4 | 2,6 | 34 | 44 | 56 | 78 | 35 | - | - |
| | Douro Amazonie | 74 | 797 | 9 | 8,4 | 2,6 | 30 | 40 | 40 | 65 | 28 | - | - |
| | Rhin Volga Douro Amazonie | 161 | 1733 | 19,4 | 8,8 | 2,6 | 58 | 68 | 90 | 143 | 63 | 90 | 140 |
| 8 | Elbe | 36 | 388 | 8,5 | 3,7 | 2,6 | 20 | 22 | 20 | 30 | - | - | - |
| 9 | Gange | 32 | 344 | 7 | 4,5 | 2,6 | 16 | 20 | 18 | 22 | - | - | - |
| 10 | Nil | 32 | 344 | 7 | 4,5 | 2,6 | 16 | 20 | 18 | 22 | - | - | - |
| 11 | Colorado | 40 | 431 | 8 | 5 | 2,6 | 18 | 20 | 20 | 35 | - | - | - |
| 12 | Missouri | 40 | 431 | 8 | 5 | 2,6 | 18 | 20 | 20 | 35 | - | - | - |
| 13 | Danube | 213 | 2293 | 18,5 | 11,5 | 2,4 | - | - | - | - | - | 120 | 250 |

FLOOR PLAN LEVEL 3 "ESPACE EIFFEL"

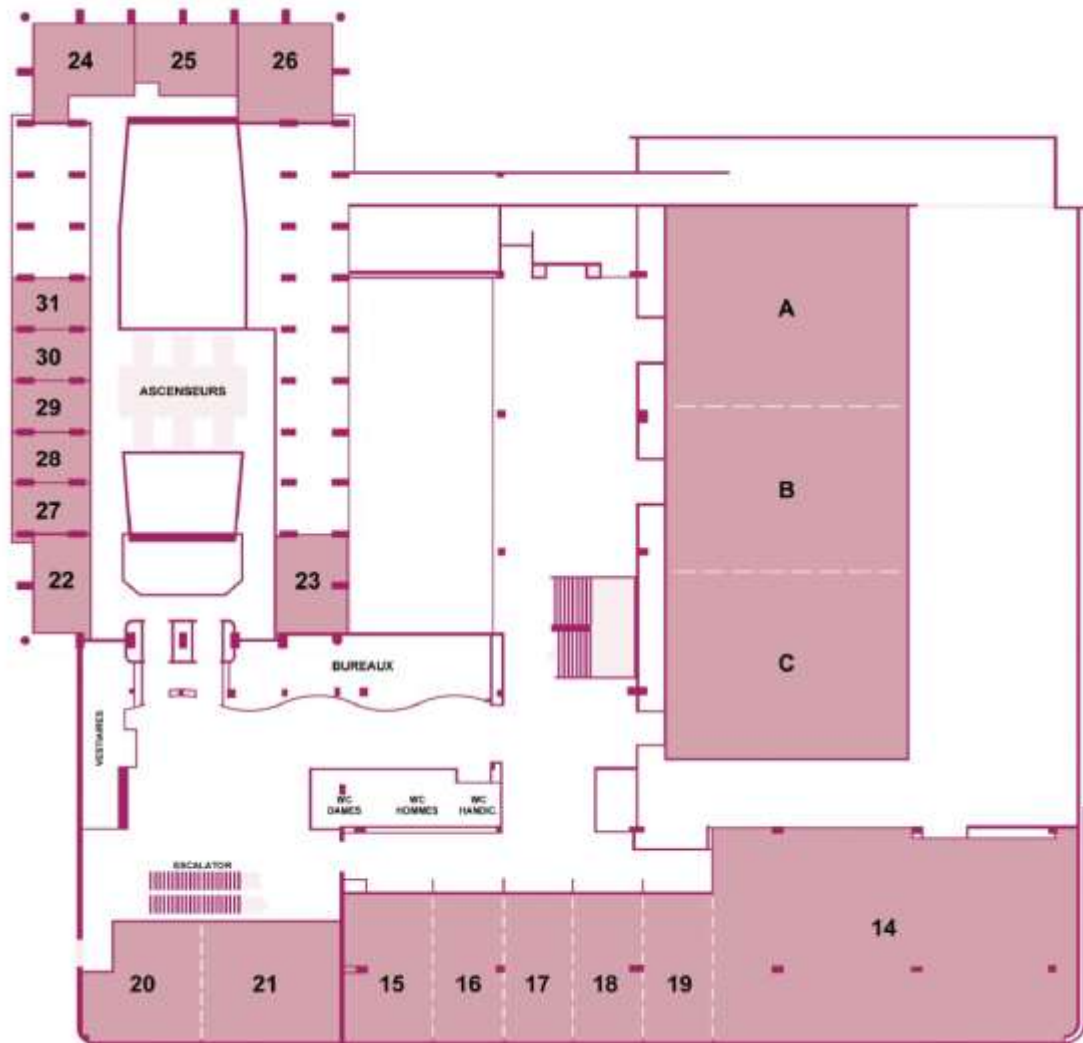

MEETING ROOM CAPACITY ESPACE EIFFEL

| ESPACE EIFFEL Niv 3 | Salon / Meeting Room | Surface m2 / Area m2 | Surface / Square Feet | Longueur / Length | largeur / width | Hauteur sous plafond / Ceiling height | U ouvert / U shape | U fermé / Boardroom | Classe / Classroom | Théâtre / Theatre | Cabaret / Cabaret by 7 | Banquet / Banquet | Cocktail / Cocktail |
|---------------------------|-------------------------|-------------------------|--------------------------|----------------------|--------------------|---|-----------------------|------------------------|-----------------------|----------------------|---------------------------|----------------------|------------------------|
| A | Amphithéâtre A | 216 | 2325 | 16 | 13,5 | 6 | - | - | 120 | 180 | 63 | 120 | 200 |
| B | Amphithéâtre B | 184 | 1981 | 16 | 11,5 | 6 | - | - | 120 | 180 | 63 | 150 | 200 |
| C | Amphithéâtre C | 200 | 2153 | 16 | 12,5 | 6 | - | - | 120 | 180 | 63 | 180 | 200 |
| | Amphithéâtre AB | 400 | 4306 | 22 | 18 | 6 | - | - | 150 | 240 | 140 | 250 | 400 |
| | Amphithéâtre ABC | 600 | 6458 | 34 | 16 | 6 | - | - | 250 | 400 | 245 | 400 | 700 |
| 14 | Trocadéro | 362 | 3897 | 25 | 14,5 | 2,7 | - | - | - | - | - | 300 | 400 |
| 15 | Louvre | 45 | 484 | 10 | 6 | 2,7 | 24 | 20 | 20 | 25 | 28 | 40 | 50 |
| 16 | Palais Royal | 45 | 484 | 10 | 4,5 | 2,7 | 24 | 24 | 25 | 30 | 28 | 40 | 50 |
| 17 | Bastille | 45 | 484 | 10 | 4,5 | 2,7 | 24 | 24 | 25 | 30 | 28 | 40 | 50 |
| 18 | Notre Dame | 45 | 484 | 10 | 4,5 | 2,7 | 22 | 24 | 25 | 30 | 28 | 40 | 50 |
| 19 | Grand Palais | 45 | 484 | 10 | 4,5 | 2,7 | 22 | 24 | 25 | 30 | 28 | 40 | 50 |
| | Trocadéro & Louvre | 587 | 6317 | 75 | - | 2,7 | - | - | - | - | - | 500 | 650 |
| 20 | Concorde | 66 | 710 | 8,1 | 8,1 | 2,7 | 20 | 20 | 32 | 40 | 28 | 48 | 50 |
| 21 | Invalides | 76 | 818 | 9,4 | 8,1 | 2,7 | 28 | 25 | 40 | 75 | 35 | 60 | 80 |
| | Invalides Concorde | 76 | 1528 | 17,5 | 8,1 | 2,7 | 28 | 25 | 40 | 75 | 49 | 60 | 80 |
| 22 | Panthéon | 24 | 258 | 6,5 | 3,7 | 2,7 | 14 | 14 | 16 | 20 | - | - | - |
| 23 | Sorbonne | 29 | 312 | 6,5 | 4,5 | 2,7 | 16 | 16 | 16 | 24 | - | - | - |
| 24 | Opéra | 29 | 312 | 6,5 | 4,5 | 2,5 | 16 | 16 | 16 | 24 | - | - | - |
| 25 | Orsay | 29 | 312 | 6,5 | 4,5 | 2,5 | 16 | 16 | 16 | 24 | - | - | - |
| 26 | Odéon | 40 | 431 | 6,5 | 6,2 | 2,5 | 18 | 16 | 18 | 30 | - | - | - |
| 27 | Vendôme | 18 | 194 | 6 | 3 | 2,6 | - | 10 | - | 15 | - | - | - |
| 28 | Vosges | 18 | 194 | 6 | 3 | 2,6 | - | 10 | - | 15 | - | - | - |
| 29 | Victoire | 18 | 194 | 6 | 3 | 2,6 | - | 10 | - | 15 | - | - | - |
| 30 | Valois | 18 | 194 | 6 | 3 | 2,6 | - | 10 | - | 15 | - | - | - |



AMPHITHEATER A-B-C

TECHNICAL SHEET 2022

Screen :

- 8*6m Cycling screen
- 1 20000 Lumens HD laser Beamer

Sound system :

- 1 Mixing console
- 1 Stage box
- Auditorium sound package
- 1 Set of 2 Shure SM58 H51 532-598 Mhz handheld HF microphones
 - 2 Shure QLXD4 H51 UHF Receiver
 - 2 Shure SM58 QLX H51 534-598 Mhz hand transmitter
- 1 Set of 2 Shure MX 412 gooseneck microphone
 - 2 Shure MX 412S gooseneck microphones
 - 2 AT8615 table base for gooseneck

Lighting :

- 1 Table lamp
- 2 DMX Splitters 4 starts
- 4 RGBW LED Fresnel 1600 to 6500k – 18° to 55° 5-pin DMX input / output
- 4 Projector White LED cut-out 25° 5600K Dimmable / 19 white LEDs

Furniture :

- Raw scene 10 modules available maximum
- Raw hotel podium element – 2.44m x 1.83m x 0.4m

For information :

- Additional services and equipments will be quoted.
- Only the hanging of signage element is authorized on our structures.
- Our staff is the only one authorized to use our equipment
- In case of use of our equipment by another provider, a technical coordinator will be invoiced € 510 (excluding VAT) per day
- Technical package 10 hours : € 490 excluding VAT.
- Technical manager package 10 hours : € 510 excluding VAT.
- (Additional hour between 7 am – 10 pm : € 75 per hour)
- (Additional hour between 10pm – 7 am : € 85 per hour).

FRÉQUENCE



CSR (CORPORATE SOCIAL RESPONSABILITY)

At Novotel Paris Centre Tour Eiffel, our customers and co-workers are involved/included in our responsible approach for a sustainable experience! Sustainable development is at the heart of our vision and our hospitality practices. Our hotel is proud to be awarded the **Green Key label**, a benchmark of excellence for sustainable tourism and hospitality. As the first international sustainable tourism label for tourist accommodation and restaurants in France, this label recognizes our commitments to sustainable development, such as the installation of presence detectors to reduce energy consumption, the strengthening of our vegetarian and organic offer with an increase in organic and/or local products, and the creation of a CSR committee to encourage the emergence of new ideas 💡

On the customer side :



We encourage our customers to reuse their bed sheets and bath towels



We use eco-labeled cleaning products



We host activities to raise our customer's awareness on sustainable topics

On the Food & Beverage side:



We have eliminated plastic bottles



We proscribed the use of threatened fish species



We offer responsible, regional and seasonal products



We are actively involved in the fight against food waste and recycle leftovers, in partnership with actors like Moulinot



We have connected scales that enable us to analyse food waste



On our menu, the carbon footprint of our menus is indicated

On the hotel side :



We aim to reduce our carbon footprint every year by taking action on energy, food and waste reduction



We have a number of waste recovery service providers so that all waste can be recycled



We have a CSR committee that represents every department in the hotel, so that new ideas can emerge



We emphasize inclusivity within our company



Finally, we collaborate with local actors in our community for an even more positive impact

ALL MEETING PLANNER

Perfect event, perfectly rewarded.

By joining ALL Meeting Planner Loyalty Program, you will be rewarded with Points ALL* for this event.

MEETING PLANNER

Your Top 3 Advantages

Earn 1 Point for every 2€ spent
At each eligible event and hotel

Pay up to 15% of an event bill
With points

Offer

Your ALL Meeting Planner Reward
Points to another ALL Member ...



MEETING PLANNER
Perfect events. Perfectly rewarded.

Join now



*estimated points based on the current proposal, definitive points will be earned after departure date and final payment received



**NO
VO
TEL**